

AMBITO DEL PLAN ESPECIAL
INCLUYENDO ACCESO=51.081,14 M2

8 cesión viales. serv. 110,58 M2 ORD.13 V.P.

1 P.LUCR-PRUDISA-1 5.286,30 m2 ORD.5-RUI-1

10 cesión viales. serv. 160,30 M2 ORD.13 V.P.

7 P.LUCR-AYUNT. 798,00 m2 ORD.5-RUI-1

2 DOTACIONAL DEP. 3.039,42 M2 ORD.9-DC

3 Z.V.PASEO PEAT. 2.253 M2 ORD.10-LUP-PR

1 SERV. EMISAROL 1.690 M2 ORD.11-SP

4 SERV. ARROYO 1.827 M2 ORD.10-LUP-PR

2 P.LUCR-PRUDISA-2 3.002,83 m2 ORD.5-RUI-1

3 P.LUCR-AYUNT. 798,00 m2 ORD.5-RUI-1

9 Z.V. VERDE 1.588,66 m2 ORD.10-LUP-PP

2 DOTAC. 643,4 M2 ORD.9-DC

4 DOTAC. 676,8 M2 ORD.9-DC

1 P.LUCR-PRUDISA-1 3.002,83 m2 ORD.5-RUI-1

5 Z.V. VERDE 1.030 M2 ORD.10-LUP-PP

7 CESIÓN VIALES 3.989,38 M2 ORD.13 V.P.

6 P.LUCRAT. B-2 9.200,62 m2 ORD.5-RUI-1

3 Z.V. VERDE 1.588,66 m2 ORD.10-LUP-PP

2 DOTAC. 643,4 M2 ORD.9-DC

1 P.LUCR-PRUDISA-1 3.002,83 m2 ORD.5-RUI-1

4 DOTAC. 676,8 M2 ORD.9-DC

6 P.LUCRAT. B-1 6.102 m2 ORD.5-RUI-1

8 CESIÓN VIALES 3.989,38 M2 ORD.13 V.P.

- AMBITO DEL PLAN ESPECIAL INCLUYENDO ACCESO
- ZONA DE POLICIA
- ZONA DE SERVIDUMBRE DEL ARROYO
- FONDO DEL CAUCE
- MCO ARROYOS
- ZONAS INUNDABLES

COORDENADAS UTM								
1	X=441827.66	Y=4496431.25	50	X=441854.85	Y=4496215.00	99	X=441707.47	Y=4496373.49
2	X=441835.16	Y=4496414.63	51	X=441862.85	Y=4496205.66	100	X=441697.85	Y=4496365.34
3	X=441856.19	Y=4496400.90	52	X=441869.99	Y=4496200.32	101	X=441695.18	Y=4496363.35
4	X=441874.40	Y=4496387.64	53	X=441874.40	Y=4496195.84	102	X=441701.84	Y=4496361.11
5	X=441828.06	Y=4496403.87	54	X=441858.11	Y=4496195.38	103	X=441695.38	Y=4496359.09
6	X=441839.43	Y=4496402.62	55	X=441860.79	Y=4496191.13	104	X=441695.30	Y=4496357.26
7	X=441812.04	Y=4496396.17	56	X=441863.00	Y=4496186.79	105	X=441695.80	Y=4496355.43
8	X=441819.65	Y=4496393.44	57	X=441872.04	Y=4496184.27	106	X=441692.30	Y=4496353.06
9	X=441800.29	Y=4496389.61	58	X=441875.08	Y=4496181.00	107	X=441698.12	Y=4496351.48
10	X=441800.67	Y=4496389.67	59	X=441877.46	Y=4496174.56	108	X=441697.08	Y=4496352.42
11	X=441793.15	Y=4496394.58	60	X=441879.86	Y=4496169.85	109	X=441693.82	Y=4496346.31
12	X=441798.24	Y=4496389.44	61	X=441874.82	Y=4496161.33	110	X=441691.47	Y=4496342.07
13	X=441797.12	Y=4496386.41	62	X=441868.40	Y=4496163.33	111	X=441537.70	Y=4496241.98
14	X=441782.98	Y=4496386.12	63	X=441849.86	Y=4496166.48	112	X=441549.09	Y=4496235.06
15	X=441791.19	Y=4496382.75	64	X=441838.00	Y=4496162.27	113	X=441531.47	Y=4496238.89
16	X=441783.92	Y=4496377.24	65	X=441826.56	Y=4496162.36	114	X=441539.25	Y=4496231.88
17	X=441788.19	Y=4496374.36	66	X=441811.90	Y=4496157.94	115	X=441547.37	Y=4496221.89
18	X=441792.12	Y=4496366.41	67	X=441804.86	Y=4496159.71	116	X=441551.09	Y=4496216.73
19	X=441772.44	Y=4496360.24	68	X=441779.84	Y=4496150.54	117	X=441529.66	Y=4496214.58
20	X=441776.89	Y=4496357.85	69	X=441805.27	Y=4496147.00	118	X=441507.54	Y=4496214.98
21	X=441760.78	Y=4496347.37	70	X=441811.95	Y=4496142.95	119	X=441506.89	Y=4496213.75
22	X=441764.83	Y=4496344.25	71	X=441815.08	Y=4496137.12	120	X=441503.12	Y=4496219.05
23	X=441768.97	Y=4496340.00	72	X=441814.72	Y=4496131.98	121	X=441497.40	Y=4496217.09
24	X=441772.95	Y=4496338.00	73	X=441803.32	Y=4496127.74	122	X=441504.22	Y=4496216.50
25	X=441733.87	Y=4496324.76	74	X=441803.40	Y=4496125.69	123	X=441517.78	Y=4496212.19
26	X=441738.37	Y=4496322.01	75	X=441819.69	Y=4496125.09	124	X=441524.09	Y=4496216.96
27	X=441742.98	Y=4496319.15	76	X=441819.15	Y=4496121.46	125	X=441522.08	Y=4496213.74
28	X=441746.29	Y=4496315.45	77	X=441815.45	Y=4496120.20	126	X=441530.69	Y=4496213.09
29	X=441729.67	Y=4496305.78	78	X=441802.93	Y=4496117.75	127	X=441522.49	Y=4496217.75
30	X=441734.17	Y=4496303.42	79	X=441826.92	Y=4496124.92	128	X=441538.55	Y=4496317.39
31	X=441738.87	Y=4496301.04	80	X=441833.37	Y=4496117.18	129	X=441561.12	Y=4496302.39
32	X=441725.47	Y=4496295.29	81	X=441835.00	Y=4496115.22	130	X=441528.76	Y=4496340.63
33	X=441729.02	Y=4496289.52	82	X=441809.04	Y=4496112.80	131	X=441541.11	Y=4496310.52
34	X=441731.21	Y=4496285.81	83	X=441817.89	Y=4496113.92	132	X=441541.66	Y=4496322.67
35	X=441714.14	Y=4496281.34	84	X=441811.89	Y=4496109.60	133	X=441543.38	Y=4496324.01
36	X=441697.34	Y=4496277.19	85	X=441805.06	Y=4496110.80	134	X=441537.26	Y=4496347.78
37	X=441700.84	Y=4496273.09	86	X=441800.61	Y=4496106.04	135	X=441526.51	Y=4496345.11
38	X=441704.63	Y=4496269.98	87	X=441800.98	Y=4496103.97	136	X=441571.66	Y=4496331.66
39	X=441684.20	Y=4496261.73	88	X=441800.68	Y=4496104.95	137	X=441562.65	Y=4496336.32
40	X=441687.72	Y=4496259.15	89	X=441800.09	Y=4496103.00	138	X=441567.87	Y=4496335.84
41	X=441691.44	Y=4496254.44	90	X=441805.70	Y=4496102.02	139	X=441592.51	Y=4496338.81
42	X=441699.27	Y=4496249.42	91	X=441800.44	Y=4496100.14			
43	X=441672.60	Y=4496245.09	92	X=441805.09	Y=4496116.73			
44	X=441682.81	Y=4496244.93	93	X=441805.49	Y=4496102.19	142	X=441646.96	Y=4496345.46
45	X=441680.03	Y=4496240.92	94	X=441802.32	Y=4496112.78	143	X=441692.73	Y=4496319.51
46	X=441657.97	Y=4496232.12	95	X=441802.32	Y=4496112.78	144	X=441692.73	Y=4496319.51
47	X=441681.03	Y=4496227.35	96	X=441804.07	Y=4496113.53	145	X=441615.33	Y=4496303.59
48	X=441638.25	Y=4496229.82	97	X=441804.07	Y=4496113.53			
49	X=441642.67	Y=4496221.52	98	X=441806.80	Y=4496211.52			

O C O - U R B A N C O M P L E X
A R Q U I T E C T O R D I R E C T O R C A R L O S O L M O S

GRAN VÍA 31, 3º 17' - 28013 MADRID - 452 84 988 / 91 532 28 45 - co@occo-urbancomplex.com

BONOS INMOBILIARIOS SA. BONINSA

PLAN ESPECIAL AREA HOMOGENA 2.4. AMBITO FORMADO POR LAS UES 2.1, 2.2 Y 2.3
ZONA DEL SOTO DE VÑUELAS. TRES CANTOS, MADRID

ORDENACION PROYECTADA

CALE DOCTOR FLEMING 31, 1º A 28036 MADRID

28036 MADRID

Boninsa

P 05 r

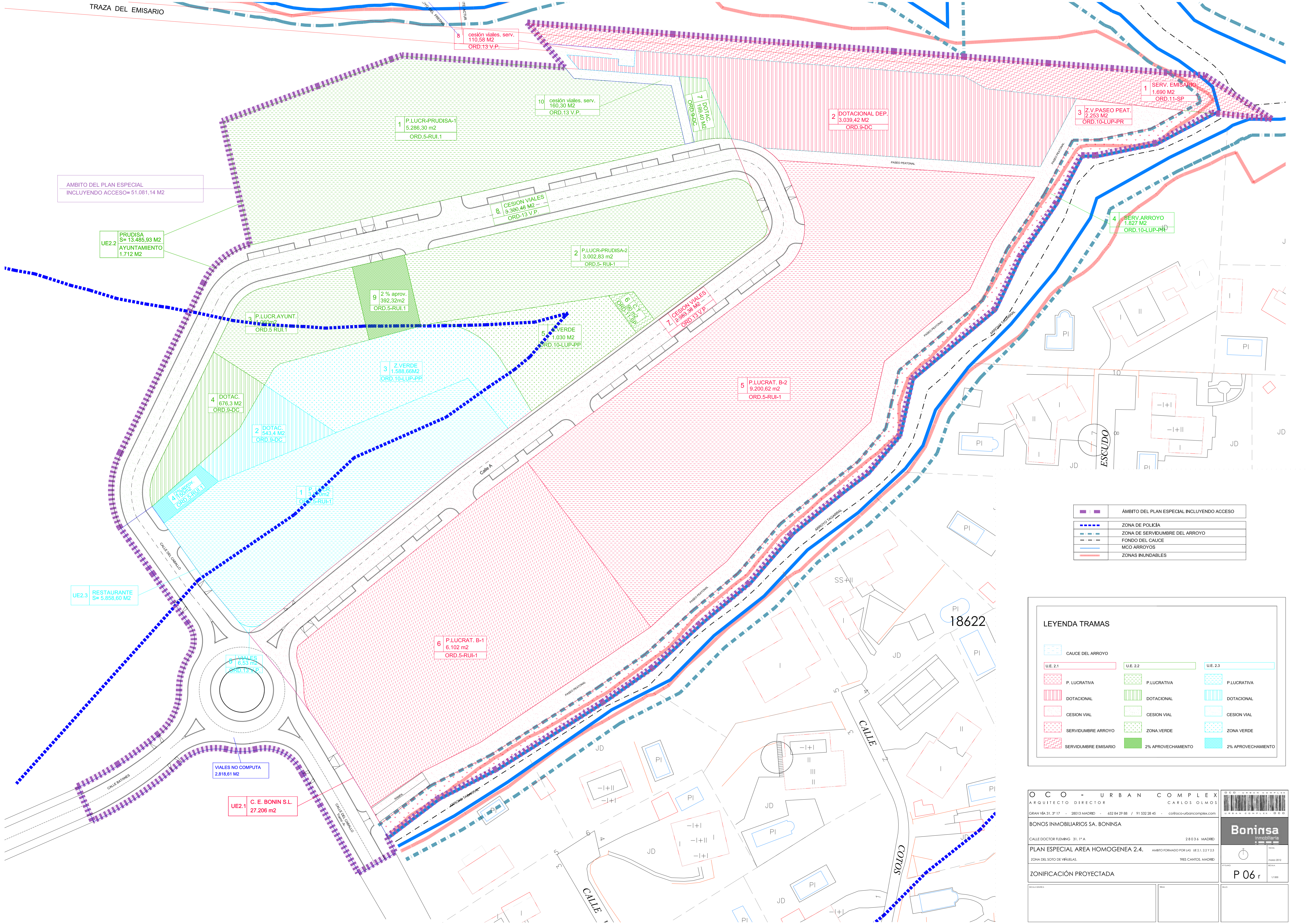

AMBITO DEL PLAN ESPECIAL
INCLUYENDO ACCESO= 51.081,14 M2

UE2.2 PRUDISA
S= 13.485,93 M2
AYUNTAMIENTO
1.712 M2

UE2.3 RESTAURANTE
S= 5.858,60 M2

VIALES NO COMPUTA
2.818,61 M2

UE2.1 C. E. BONIN S.L.
27.206 m2

1 SERV. EMISARIO
1.690 M2
ORD.11-SP

3 Z.V.PASEO PEAT.
2.253 M2
ORD.10-LUP-PR

4 SERV. ARROYO
1.827 M2
ORD.10-LUP-PR

5 P.LUCRAT. B-2
9.200,62 m2
ORD.5-RUI-1

1 P.LUCR-PRUDISA-1
5.286,30 m2
ORD.5-RUI.1

10 cesión viales. serv.
160,30 M2
ORD.13 V.P.

7 CESION VIALES
2.988,28 M2
ORD.13 V.P.

2 P.LUCR-PRUDISA-2
3.002,83 m2
ORD.5-RUI-1

9 2% aprov.
392,32m2
ORD.5-RUI.1

5 Z.VERDE
1.030 M2
ORD.10-LUP-PP

3 Z.VERDE
1.588,66M2
ORD.10-LUP-PP

3 P.LUCR.AYUNT.
1.712 M2
ORD.5 RUI.1

4 DOTAC.
676,3 M2
ORD.9-DC

2 DOTAC.
543,4 M2
ORD.9-DC

1 P.LUCR.
3.700 M2
ORD.5-RUI-1

6 P.LUCRAT. B-1
8.102 m2
ORD.5-RUI-1

	ÁMBITO DEL PLAN ESPECIAL INCLUYENDO ACCESO
	ZONA DE POLICIA
	ZONA DE SERVIDUMBRE DEL ARROYO
	FONDO DEL CAUCE
	MCO ARROYOS
	ZONAS INUNDABLES

LEYENDA TRAMAS			
	CAUCE DEL ARROYO		U.E. 2.2
	P. LUCRATIVA		P. LUCRATIVA
	P. LUCRATIVA		P. LUCRATIVA
	DOTACIONAL		DOTACIONAL
	DOTACIONAL		DOTACIONAL
	CESION VIAL		CESION VIAL
	CESION VIAL		CESION VIAL
	SERVIDUMBRE ARROYO		ZONA.VERDE
	SERVIDUMBRE EMISARIO		ZONA VERDE
	2% APROVECHAMIENTO		2% APROVECHAMIENTO

O C O - U R B A N C O M P L E X
ARQUITECTO DIRECTOR CARLOS OLMOS

GRAN VÍA 31, 3º 17 - 28013 MADRID - 652 84 29 88 / 91 532 28 45 - co@oco-urbancomplex.com

BONOS INMOBILIARIOS SA. BONINSA

CALLE DOCTOR FLEMING 31, 1º A 28036 MADRID

PLAN ESPECIAL AREA HOMOGENA 2.4. AMBITO FORMADO POR LAS U.E. 2.1, 2.2 Y 2.3
ZONA DEL SOTO DE VIEJUELAS. TRES CANTOS MADRID

ZONIFICACIÓN PROYECTADA

P 06_r